

CZ 230

120 Watt max

4 Ω

ellittico 230x160 mm / 9"x6"

COASSIALI

2 Vie coassiali, membrana woofer in polipropilene, tweeter in neodimio

2 Way coax, polypropylene cone, neodymium tweeter

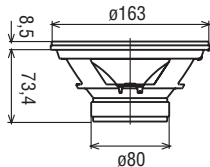

Potenza nominale **50 W**

Impedenza nominale **4 Ω**

Sensibilità (1W/1m) **94 dB**

\varnothing bobina mobile **25 mm**

Altezza traferro **4 mm**

Fori di fissaggio **4 $\varnothing 7$ ■ 165x120**

Foro pannello **ell.220x151mm**

Re **3,5 Ω**

Fs **66 Hz**

Qms **3,11**

Qes **1,55**

Qts **1,03**

Mms **11,53 g**

Cms **0,50 mm/N**

D **177 mm**

Vas **42,23 dm³**

Bxl **3,29 Wb/m**

Xmax **1,7 mm**

η°

Le

Peso **0,86 Kg**